



Facet P/N: Assembly 037762-01  
Element 038072

## 8 GPM Jet Fuel Filter Assembly

### Specifications

**Rated Flow:** 8 gpm

**Fluid:** Jet fuel

**Pressure Drop at Rated Flow:** 10 psi

**Degree of Filtration:** 10 micron nominal

**Operating Pressure:** 3000 psi

**Burst pressure:** 12,000 psi

**Temperature range:** -65°F to 300°F

**Relief Valve Cracking Pressure:** 50±5 psi

**Housing Material:** Aluminum alloy (anodized)

**Element Material:** Micropleat® media

**Weight:** 1.9 lbs

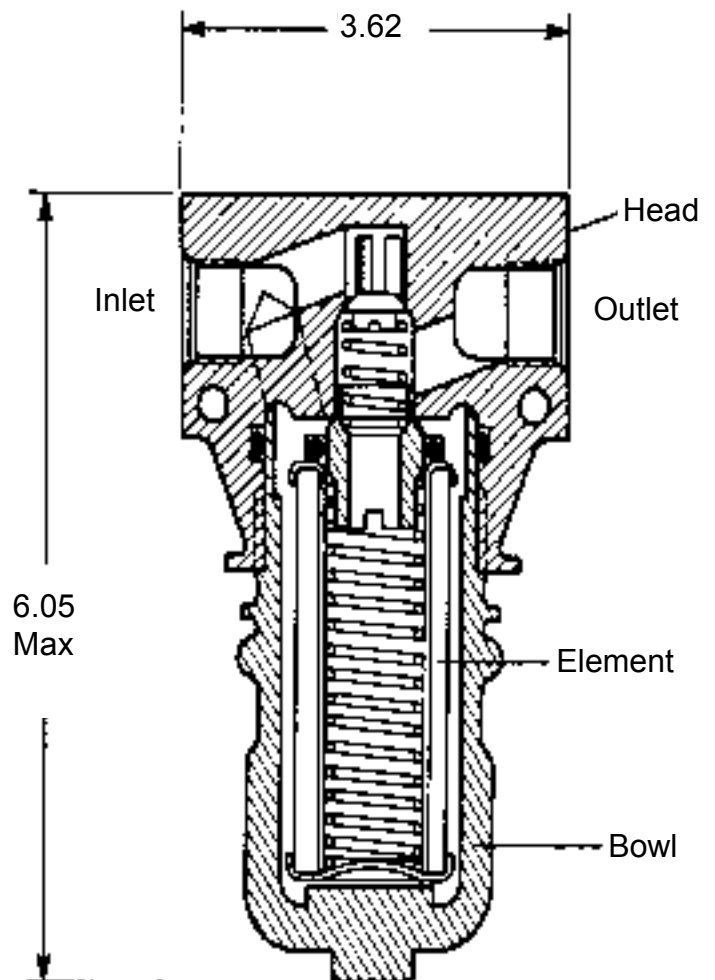

# Facet Part No.: Assembly 037762-01 Element 038072

## 8 GPM Jet Fuel Filter Assembly

### Parts List

ItemNo.	PartNo.	Nomenclature	No. per Assembly	ItemNo.	PartNo.	Nomenclature	No. per Assembly
1	568997	Lockwire(AMS-5685)	1	*7	569591	Nipple	1
2	570015	Bowl	1	*8	569592	Lockwasher & Gasket	1
3	038072	Element Assembly	1	*9	569376	Spring	1
4	055297-01	O-ring Packing	1	*10	569375-01	Valve	1
5	910790	Ring Backup	2	*11	569507	Head	1
6	055295	O-ring Packing	1	*Items 7,8,9,10,11 not sold separately. Use Head Assembly 1745349			

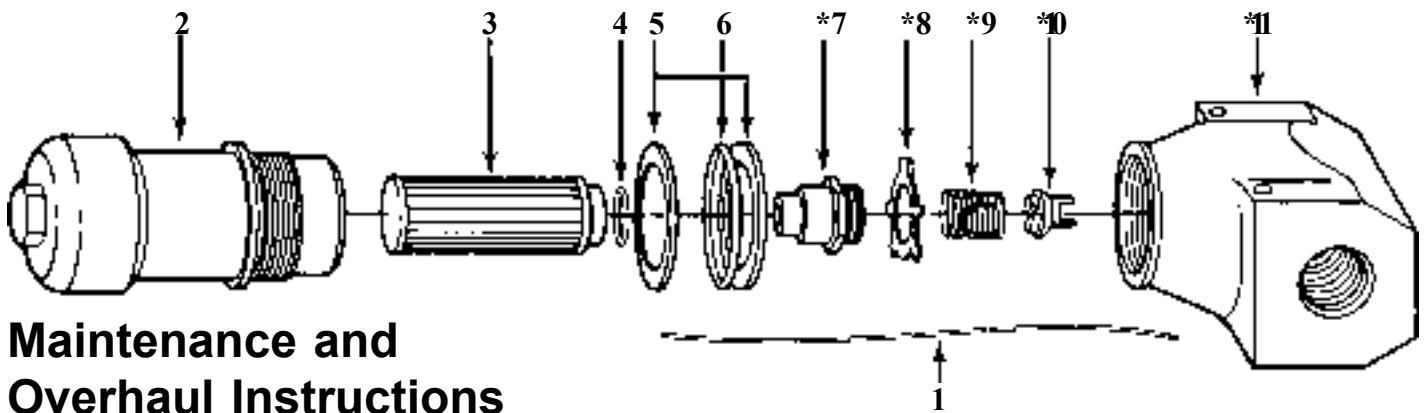

### Maintenance and Overhaul Instructions

**Disassembly:** Disassembly of the filter follows the sequence of the assigned item numbers in exploded view.

**Cleaning:** Wash metal parts in a suitable solvent such as trichloroethylene, carbon tetrachloride, stoddard solvent, etc. The filter element is of the disposable type and cleaning is not recommended.

**Inspection:** Head and bowl (Items 11 and 2) should be examined for distorted threads or scoring.

**Replacement Items:** Replace O-ring packing (Items 4 and 6), backup rings (Item 5) and filter element (Item 3).

**Test:** Test bypass valve for proper operation by plugging the hole in the nipple (Item 7). Reassemble the filter leaving the filter element out. Gradually apply hydraulic oil pressure to the inlet. At 40 psi, the leakage through the valve must not exceed 40 drops per minute. Valve must crack open at 50±5 psi. Excessive leakage indicates a damaged valve or seat. This may be repaired by lapping lightly using a thin film of lapping compound, Federal Spec No. SS-C-614, and rotating valve with a screwdriver. Clean all parts thoroughly before reassembly.

**Reassembly:** Reassemble in reverse order of disassembly. Lockwasher (Item 8) can be reused by straightening bent tab and bending a tab into one of the 0.406 diameter inlet holes in the head after tightening nipple (Item 7). Lubricate threads and O-ring packings with a small amount of MIL-L-4343 lubricant. Replace lockwire.